

## Adapteur male JIC x male JIC

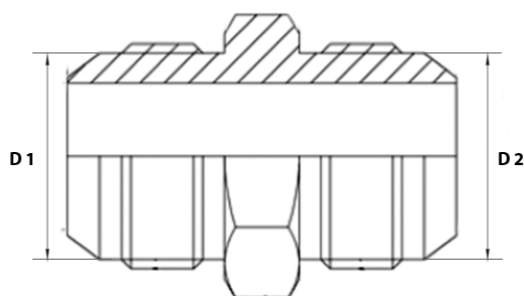

Adapteur male JIC x male JIC

**Matière :** acier  
**Norme :** SAE-J514 (ISO 8434-2)  
**Type :** 2024

Code	Référence	D1	D2	D3	Poids
077543	AD MJ3/8XMJ3/8	MALE 3/8"	MALE 3/8"		0
005223	AD MJ7/16XMJ7/16	MALE 7/16"	MALE 7/16"		0.018
005117	AD MJ1/2XMJ7/16	MALE 1/2"	MALE 7/16"		0
005115	AD MJ1/2XMJ1/2	MALE 1/2"	MALE 1/2"		0.02
005263	AD MJ9/16XMJ7/16	MALE 9/16"	MALE 7/16"		0
005262	AD MJ9/16XMJ1/2	MALE 9/16"	MALE 1/2"		0
005264	AD MJ9/16XMJ9/16	MALE 9/16"	MALE 9/16"		0.027
073190	AD MJ3/4XMJ1/2	MALE 3/4"	MALE 1/2"		0
005207	AD MJ3/4XMJ9/16	MALE 3/4"	MALE 9/16"		0
005205	AD MJ3/4XMJ3/4	MALE 3/4"	MALE 3/4"		0.063
005241	AD MJ7/8XMJ3/4	MALE 7/8"	MALE 3/4"		0
005242	AD MJ7/8XMJ7/8	MALE 7/8"	MALE 7/8"		0.084
005135	AD MJ1"1/16XMJ3/4	MALE 1"1/16	MALE 3/4"		0
005136	AD MJ1"1/16XMJ7/8	MALE 1"1/16	MALE 7/8"		0
005133	AD MJ1"1/16XMJ1"1/16	MALE 1"1/16	MALE 1"1/16		0.135
043213	AD MJ1"3/16XMJ1"1/16	MALE 1"3/16	MALE 1"1/16		0
005153	AD MJ1"5/16XMJ1"1/16	MALE 1"5/16	MALE 1"1/16		0
005154	AD MJ1"5/16XMJ1"5/16	MALE 1"5/16	MALE 1"5/16		0.2
005168	AD MJ1"5/8XMJ1"5/16	MALE 1"5/8	MALE 1"5/16		0
005169	AD MJ1"5/8XMJ1"5/8	MALE 1"5/8	MALE 1"5/8		0.31
005180	AD MJ1"7/8XMJ1"7/8	MALE 1"7/8	MALE 1"7/8		0.46
005187	AD MJ2"1/2XMJ2"1/2	MALE 2"1/2	MALE 2"1/2		0