

Adapteur male JIC x male SAE

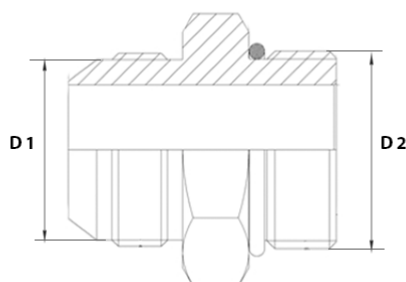

MALE BSP JIC X MALE SAE(FILETAGE UNF)

Matière : acier
Norme : SAE-J514 (ISO 8434-2)
Type : 2005

Code	Référence	D1	D2	D3	Poids
005227	AD MJ7/16XMSAE7/16	MALE 7/16"	MALE 7/16"		0.021
005225	AD MJ7/16XMSAE1/2	MALE 7/16"	MALE 1/2"		0.024
005228	AD MJ7/16XMSAE9/16	MALE 7/16"	MALE 9/16"		0.025
005226	AD MJ7/16XMSAE3/4	MALE 7/16"	MALE 3/4"		0
005119	AD MJ1/2XMSAE7/16	MALE 1/2"	MALE 7/16"		0
005118	AD MJ1/2XMSAE1/2	MALE 1/2"	MALE 1/2"		0.024
005120	AD MJ1/2XMSAE9/16	MALE 1/2"	MALE 9/16"		0
077470	AD MJ1/2XMSAE3/4	MALE 1/2"	MALE 3/4"		0
005268	AD MJ9/16XMSAE7/16	MALE 9/16"	MALE 7/16"		0
005266	AD MJ9/16XMSAE1/2	MALE 9/16"	MALE 1/2"		0
005270	AD MJ9/16XMSAE9/16	MALE 9/16"	MALE 9/16"		0.031
005267	AD MJ9/16XMSAE3/4	MALE 9/16"	MALE 3/4"		0.05
005269	AD MJ9/16XMSAE7/8	MALE 9/16"	MALE 7/8"		0
005211	AD MJ3/4XMSAE9/16	MALE 3/4"	MALE 9/16"		0
005209	AD MJ3/4XMSAE3/4	MALE 3/4"	MALE 3/4"		0.06
005210	AD MJ3/4XMSAE7/8	MALE 3/4"	MALE 7/8"		0
005208	AD MJ3/4XMSAE1"1/16	MALE 3/4"	MALE 1"1/16		0
005245	AD MJ7/8XMSAE3/4	MALE 7/8"	MALE 3/4"		0
005246	AD MJ7/8XMSAE7/8	MALE 7/8"	MALE 7/8"		0.1
005244	AD MJ7/8XMSAE1"1/16	MALE 7/8"	MALE 1"1/16		0.138
005139	AD MJ1"1/16XMSAE3/4	MALE 1"1/16	MALE 3/4"		0.11
005140	AD MJ1"1/16XMSAE7/8	MALE 1"1/16	MALE 7/8"		0.12
005137	AD MJ1"1/16XMSAE1"1/16	MALE 1"1/16	MALE 1"1/16		0.184
005138	AD MJ1"1/16XMSAE1"5/16	MALE 1"1/16	MALE 1"5/16		0.151
005159	AD MJ1"5/16XMSAE7/8	MALE 1"5/16	MALE 7/8"		0
005156	AD MJ1"5/16XMSAE1"1/16	MALE 1"5/16	MALE 1"1/16		0.194
005157	AD MJ1"5/16XMSAE1"5/16	MALE 1"5/16	MALE 1"5/16		0.209
005158	AD MJ1"5/16XMSAE1"5/8	MALE 1"5/16	MALE 1"5/8		0.332
005171	AD MJ1"5/8XMSAE1"5/16	MALE 1"5/8	MALE 1"5/16		0
005172	AD MJ1"5/8XMSAE1"5/8	MALE 1"5/8	MALE 1"5/8		0.348
005173	AD MJ1"5/8XMSAE1"7/8	MALE 1"5/8	MALE 1"7/8		0
005182	AD MJ1"7/8XMSAE1"5/8	MALE 1"7/8	MALE 1"5/8		0
005183	AD MJ1"7/8XMSAE1"7/8	MALE 1"7/8	MALE 1"7/8		0.48
005189	AD MJ2"1/2XMSAE2"1/2	MALE 2"1/2	MALE 2"1/2		0