

Te male renversé JIC x male SAE

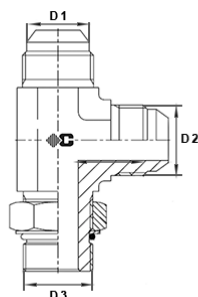

TE MALE RENVERSE JIC X MALE SAE

Matière : acier
Norme : SAE-J514 (ISO 8434-2)
Type : 2052

Code	Référence	D1	D2	D3	Poids
026004	AT TMRJ7/16XMSAE7/16	MALE 7/16"	MALE 7/16"	MALE 7/16"	0.043
032909	AT TMRJ7/16XMSAE1/2	MALE 7/16"	MALE 7/16"	MALE 1/2"	0
032910	AT TMRJ7/16XMSAE9/16	MALE 7/16"	MALE 7/16"	MALE 9/16"	0
026005	AT TMRJ1/2XMSAE1/2	MALE 1/2"	MALE 1/2"	MALE 1/2"	0.065
026006	AT TMRJ9/16XMSAE9/16	MALE 9/16"	MALE 9/16"	MALE 9/16"	0.073
032913	AT TMRJ9/16XMSAE3/4	MALE 9/16"	MALE 9/16"	MALE 3/4"	0
026007	AT TMRJ3/4XMSAE3/4	MALE 3/4"	MALE 3/4"	MALE 3/4"	0
032907	AT TMRJ3/4XMSAE7/8	MALE 3/4"	MALE 3/4"	MALE 7/8"	0
032908	AT TMRJ3/4XMSAE1"1/16	MALE 3/4"	MALE 3/4"	MALE 1"1/16	0
032911	AT TMRJ7/8XMSAE3/4	MALE 7/8"	MALE 7/8"	MALE 3/4"	0
026008	AT TMRJ7/8XMSAE7/8	MALE 7/8"	MALE 7/8"	MALE 7/8"	0.212
032912	AT TMRJ7/8XMSAE1"1/16	MALE 7/8"	MALE 7/8"	MALE 1"1/16	0
032900	AT TMRJ1"1/16XMSAE3/4	MALE 1"1/16	MALE 1"1/16	MALE 3/4"	0
032901	AT TMRJ1"1/16XMSAE7/8	MALE 1"1/16	MALE 1"1/16	MALE 7/8"	0
026009	AT TMRJ1"1/16XMSAE1"1/16	MALE 1"1/16	MALE 1"1/16	MALE 1"1/16	0.352
032902	AT TMRJ1"1/16XMSAE1"5/16	MALE 1"1/16	MALE 1"1/16	MALE 1"5/16	0
032903	AT TMRJ1"5/16XMSAE1"1/16	MALE 1"5/16	MALE 1"5/16	MALE 1"1/16	0
026010	AT TMRJ1"5/16XMSAE1"5/16	MALE 1"5/16	MALE 1"5/16	MALE 1"5/16	0.482
032904	AT TMRJ1"5/16XMSAE1"5/8	MALE 1"5/16	MALE 1"5/16	MALE 1"5/8	0
032905	AT TMRJ1"5/8XMSAE1"5/8	MALE 1"5/8	MALE 1"5/8	MALE 1"5/8	0
032906	AT TMRJ1"7/8XMSAE1"7/8	MALE 1"7/8	MALE 1"7/8	MALE 1"7/8	0