

Te male renversé ORFS x male SAE

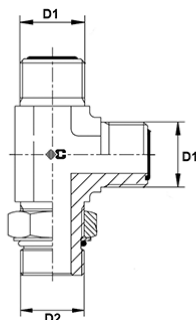

TE MALE RENVERSE ORFS X MALE SAE

Matière: acier
Norme: ORFS SAE J1453
Type : 4059

Code	Référence	D1	D2	D3	Poids
018699	AT TMRO9/16XMSAE7/16	MALE 9/16"	MALE 7/16"		0
033532	AT TMRO9/16XMSAE9/16	MALE 9/16"	MALE 9/16"		0
033533	AT TMRO9/16XMSAE3/4	MALE 9/16"	MALE 3/4"		0
033526	AT TMRO11/16XMSAE7/16	MALE 11/16"	MALE 7/16"		0
018700	AT TMRO11/16XMSAE9/16	MALE 11/16"	MALE 9/16"		0
033527	AT TMRO11/16XMSAE3/4	MALE 11/16"	MALE 3/4"		0
033529	AT TMRO13/16XMSAE9/16	MALE 13/16"	MALE 9/16"		0
018702	AT TMRO13/16XMSAE3/4	MALE 13/16"	MALE 3/4"		0
033530	AT TMRO13/16XMSAE7/8	MALE 13/16"	MALE 7/8"		0
033531	AT TMRO13/16XMSAE1"1/16	MALE 13/16"	MALE 1"1/16		0
033524	AT TMRO1"XMSAE3/4	MALE 1"	MALE 3/4"		0
018703	AT TMRO1"XMSAE7/8	MALE 1"	MALE 7/8"		0
033525	AT TMRO1"XMSAE1"1/16	MALE 1"	MALE 1"1/16		0
033520	AT TMRO1"3/16XMSAE7/8	MALE 1"3/16	MALE 7/8"		0
018704	AT TMRO1"3/16XMSAE1"1/16	MALE 1"3/16	MALE 1"1/16		0
033521	AT TMRO1"3/16XMSAE1"5/16	MALE 1"3/16	MALE 1"5/16		0
033522	AT TMRO1"7/16XMSAE1"1/16	MALE 1"7/16	MALE 1"1/16		0
018705	AT TMRO1"7/16XMSAE1"5/16	MALE 1"7/16	1"5/16		0
033523	AT TMRO1"7/16XMSAE1"5/8	MALE 1"7/16	MALE 1"5/8		0
033517	AT TMRO1"11/16XMSAE1"5/16	MALE 1"11/16	MALE 1"5/16		0
018706	AT TMRO1"11/16XMSAE1"5/8	MALE 1"11/16	MALE 1"5/8		0
033518	AT TMRO1"11/16XMSAE1"7/8	MALE 1"11/16	MALE 1"7/8		0
033534	AT TMRO2"XMSAE1"7/8	MALE 2"	MALE 1"7/8		0