

Vanne 2 voies Bride SAE - VITON

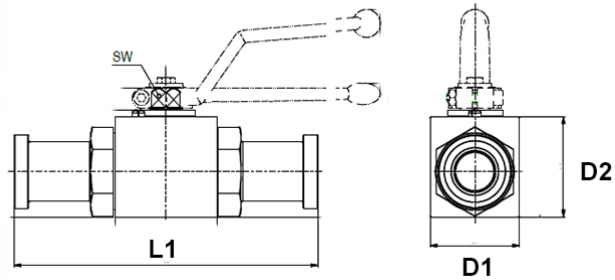

Vanne 2 voies Bride SAE - VITON

Matière: Corps Acier forgé
Boisseau Acier

Joint: FPM

Siège: POM

Température de service: -20°C à +100°C

Fabrication: Allemagne sauf rupture

Joint FPM Viton

Code	Référence	Dn	Filetage	Pression sev	L1	D1	D2	Poids
3000 PSI								
138577	VBS 13 CN 1/2 JOINT VITON	13	1/2"	420 bars	151.00	25.50	31.80	0
138576	VBS 20 CN 3/4 JOINT VITON	20	3/4"	420 bars	174.00	31.90	41.30	0
138575	VBS 25 CN 1" JOINT VITON	25	1"	350 bars	198.00	39.80	47.60	0
138578	VBS 32 CN 1"1/4 JOINT VITON	32	1"1/4	420 bars	223.00	44.60	54.00	0
138627	VBS 38 CN 1"1/2 JOINT VITON	38	1"1/2	420 bars	281.00	54.10	63.50	0
138628	VBS 50 CN 2" JOINT VITON	50	2"	420 bars	316.00	63.60	79.40	0
6000 PSI								
138629	VBS 13 CF 1/2 JOINT VITON	13	1/2"	420 bars	151.00	25.50	31.80	0
138649	VBS 20 CF 3/4 JOINT VITON	20	3/4"	420 bars	174.00	31.90	41.30	0
138650	VBS 25 CF 1" JOINT VITON	25	1"	420 bars	198.00	39.80	47.60	0
138651	VBS 32 CF 1"1/4 JOINT VITON	32	1"1/4	420 bars	223.00	44.60	54.00	0
138652	VBS 38 CF 1"1/2 JOINT VITON	38	1"1/2	420 bars	281.00	54.10	63.50	0
138653	VBS 50 CF 2" JOINT VITON	50	2"	420 bars	316.00	63.60	79.40	0